



REFRIGERATION HARDWARE SUPPLY CORPORATION

632 Foresight Circle, Grand Junction, CO 81505
Phone: (800) 716-7788 • FAX: (800) 835-6655
Email: colorado@rhsparts.com

9021 Norris Ave., Sun Valley, CA 91352
Phone: (800) 537-8300 • FAX: (800) 833-3515
Email: california@rhsparts.com

INSTALLING THREE BASIC GASKET STYLES



A

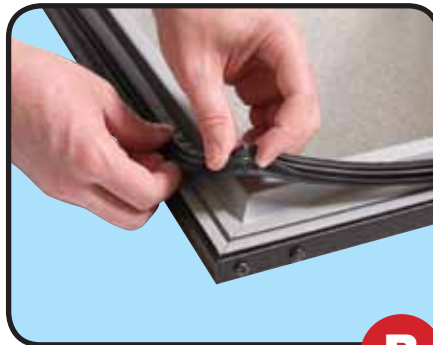

B

Dart Mounted Style

Carefully remove old gasket by separating dart on base of gasket from gray plastic retainer track. Do not remove hard plastic retainer track from door. Install new gasket by pushing dart into clean track. Start all corners first then work both sides into retainer track toward middle of gasket.



A



B

Push In Style

Remove old gasket by lifting gasket from groove around door. Mount new gasket by pushing all corners in place first. Work both sides of gasket into groove by pushing gasket toward the middle.



A



B

Screw Mounted Style

Remove old gasket by removing all screws from under flap of gasket. Install new gasket under door panel at all 4 corners first. Relocate panel and make holes in new gasket flange with punch or awl. Install screws loosely at corners first. Install remaining screws, then tighten all screws.